

Xmelt fusion

hhs
Baumer Group

Synergy between efficiency and sustainability



Xmelt fusion

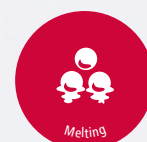

Let's stick together

baumerhhs.com

The new generation of melters

Xmelt fusion melters represent an ideal symbiosis between efficiency and sustainability, and they unite maximum ease-of-use with the performance, quality and reliability for which Baumer hhs is known worldwide. The new product line adheres closely to the **Rethink. Renew. Recycle.** philosophy of sustainability, enabling customers to improve the ecological footprint of both their packaging products and production processes long-term.

Thanks to advanced electronics, a re-designed hot melt tank and intelligent energy optimisation, Xmelt fusion melters offer maximum reliability in production at very low energy input. Even the compact “Basic” unit achieves a melt rate of up to 14 kg hot melt adhesive per hour, meaning it can handle about 90% of all packaging applications. The new product line further includes a version with automated adhesive supply as well as a “Special Volume” unit with a larger tank that is a streamlined, efficient solution.

Xmelt fusion is intuitive to operate on either a 3.5” integrated or 7” external display, and it offers smart service functions: It automatically issues maintenance notifications, compiles job-specific data on energy and adhesive consumption and stores configurations for rapid job changeovers.

With its durable metal housing, modern design, enhanced safety features and flexible configurations, Xmelt fusion represents a new generation of melters. Xmelt not only meets current demands, but also is a perfect platform for future advancements — making it a secure investment for users.

Xmelt fusion Elementary

Even in its Elementary configuration, Xmelt fusion impresses with an impressive melting capacity of up to 14 kg per hour. Thanks to its maintenance-friendly design, it offers exactly the features that make modern production more efficient, reliable and future-proof.

Basic 4kg

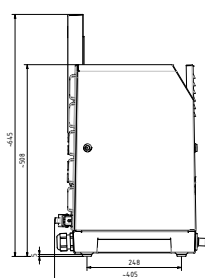
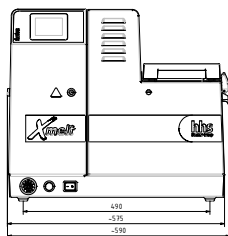

Special volume 8 kg

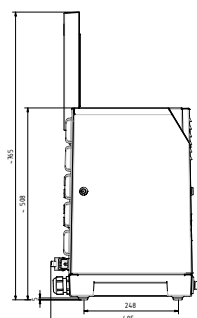
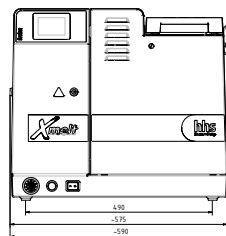

Basic feeding 4 kg

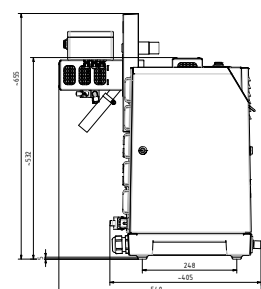
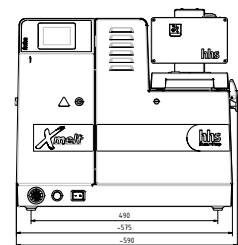

Xmelt fusion Advanced



Better overview thanks to external 7" touch display

With Xmelt fusion Advanced, operators retain full control at all times – regardless of where the melting device is integrated into the production line. The intelligent software not only provides a clear overview, but also valuable production data in real time. This is a decisive added value that creates transparency, optimises processes and ensures noticeable efficiency gains.

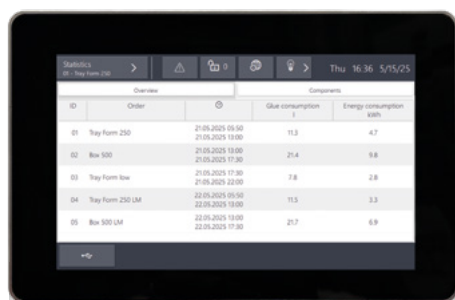
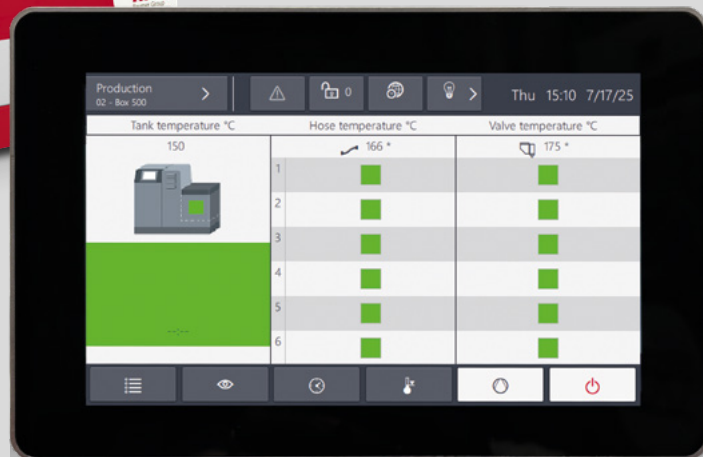

Xmelt fusion Advanced

Xmelt fusion Advanced provides job-specific values for adhesive and energy consumption.

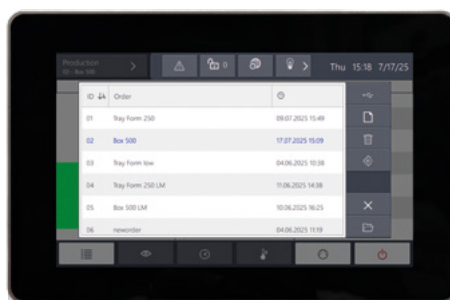

Efficiency in order management

In order management, Xmelt fusion allows you to call up a default setting in which defined parameters are automatically preset.

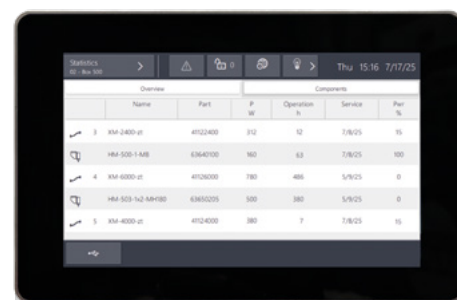

Smart Maintenance

Xmelt fusion knows the status of all connected components and provides intelligent maintenance advice.

At a glance

- High melting rate
- Energy consumption – 20%*
- Adhesive database
- Production data energy and adhesive consumption
- Two-zone melting tank
- Maintenance manager

Xmelt fusion

* Compared to previous version

Technical Data

Model	Xmelt fusion 4kg Basic	Xmelt fusion 4kg Basic feeding	Xmelt fusion 8kg Special volume
Melting rate	14 kg/h*	14 kg/h*	14 kg/h*
Performance Data			
Tank	1.6 kw	1.6 kw	1.6 kw
Channel	1.2 kw	1.2 kw	1.2 kw
IP	40/54	40/54	40/54
Electrical connection	3/PE AC 200V -240V ±10% 50/60Hz, 3/N/PE AC 400V ±10% 50/60Hz		
Compressed air	6 bar	6 bar	6 bar
Temperature range	20-200°C	20-200°C	20-200°C
Control accuracy	±0,5°C	±0.5°C	±0.5°C
max. hotmelt pressure	max. 80 bar	max. 80 bar	max. 80 bar
Ambient temperature	0...40°C	0...40°C	0...40°C
Hose connections	2-8	2-8	2-8
Weight	49 kg	52 kg	50 kg
Interfaces	Ethernet IP, Modbus, Xtend ³ , USB Optional: Ethercat, Profibus, Profi Net, DeviceNet, ControlNet		

*Dependent on adhesive

List of functions

Xmelt fusion functions	Elementary	Advanced
Pump (On/Off)	•	•
Individual temperatures for all components	•	•
Auto Eco Modus	•	•
Maintenance manager	•	•
Automatic granule feeder	•	•
Recipe management	•	•
BUS Interfaces	•	•
Adhesive data bank	•	•
Dynamic pressure control (I/P converter)		•
External flexible display		•
USB interface		•
Adhesive consumption notification		•
Energy consumption notification		•